



WQ-SQG

STAINLESS STEEL SUBMERSIBLE SWAGE PUMP



WQ-SQG

STAINLESS STEEL SUBMERSIBLE SWAGE PUMP

product description

WQ(D)-SQG submersible sewage pump with cutting device has a particularly strong discharge capacity, The tape has good cutting performance. It can shred the long fibers, plastics, paper, tape, cloth strips, straw, rope and other impurities in the sewage and then discharge them. The most advanced method is adopted to design the most reasonable hydraulic characteristics, so that the electric pump can be Full head operation, the best combination of excellent dry-type motor and water pump. The electric pump uses a high-quality silicon carbide fluorine glue machine.

•The combined surface of the double-end mechanical seal and the skeleton oil seal shall not exceed 1/2 of the height of the motor, and the temperature of the pumped dirt shall not exceed 40°C. This series of sewage and sewage diving sewage is mainly used to discharge domestic waste water, sewage, human feces and urine, and solid suspended solids and non-corrosive media containing short fiber paper chips, wood dust, silt, ore particles, etc. The temperature of the pumped liquid is not Above 40°C, the density is not more than 1200kg/m³, and the PH value is 59. The sewage pump adopts double mechanical seal and open impeller.

•20 Alloy cutter heads and impellers made of chromium, nickel and molybdenum are wear-resistant, non-clogging, non-winding, small in size, compact in structure, and convenient to carry.



Application

WQ-SQG band cutting device submersible sewage pump is mainly used for engineering sewage and domestic sewage.

- Used in construction sites, engineering foundation construction, municipal facilities, and waterworks.
- Sewage discharge from the basements of various high-rise buildings, air defense potholes, subways and other underground layers.
- Sewage treatment and circulating water transportation for small and medium-sized enterprises.
- Slag slurry pumping from factories and mines such as food, paper, brewing, steel and non-ferrous metals, tanning, textiles, pharmaceuticals, cement plants, etc.
- Chicken farms, pig farms, various breeding industries, fish ponds for pumping water and clearing ponds, septic tanks and other occasions for human and animal excrement and urine pumping.



Model Description

50 WQ 15 - 15 - 1.5 SQG

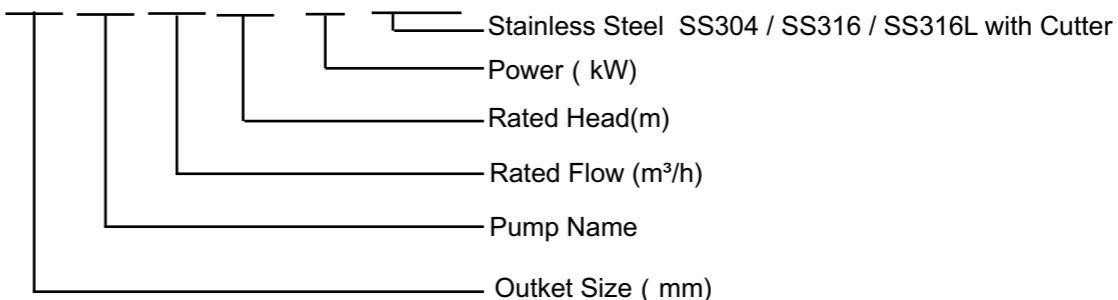

Pump Drawing

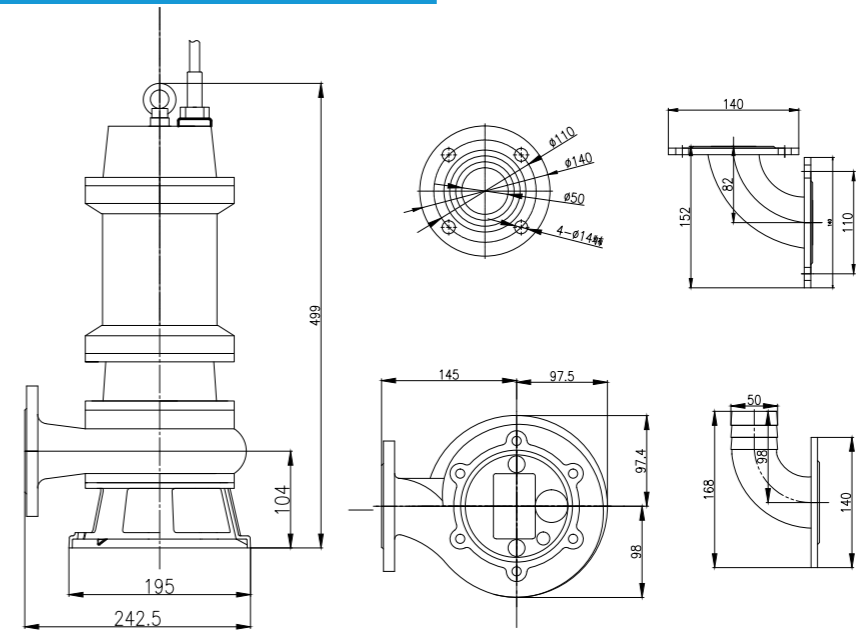

Pump Model

Model	Rated FLOW	Rated Head	Power	Voltage	Speed	Outlet Size	Packing Dimension
	m³/h	m	kW	V	rpm	mm	cm
50WQ(D)10-10-0.75 SQG	10	10	0.75	220/380	2850	50	54*22*25
50WQ(D)10-13-1.1SQG	10	13	11	220/380	2850	50	58*22*26
50WQ(D)15-13-1.5SQG	15	13	1.5	220/380	2850	50	58*22*26
65WQ(D)25-7-1.5SQG	25	7	1.5	220/380	2850	65	58*22*26
50WQ(D)15-18-2.2SQG	15	18	2.2	220/380	2850	50	58*22*26
65WQ(D)25-13-2.2SQG	25	13	2.2	220/380	2050	65	58*22*25
80WQ(D)35-9-2.2SQG	35	9	2.2	220/380	2850	80	58*22*26
50WQ15-25-3SQG	15	25	3	380	2850	50	64*24*28



WQ-SQG

STAINLESS STEEL SUBMERSIBLE SWAGE PUMP

Model	Rated Flow	Rated Head	Power	Voltage	Speed	Outlet Size	Packing Dimension
	m ³ /h	m	kW	V	rpm	mm	cm
65WQ25-18-3SQG	25	18	3	380	2850	65	64*24*28
80WQ35-13-3SQG	35	13	3	380	2050	80	64*24*20
50WQ15-32-4SQG	15	32	4	380	2850	50	71*28*34
65WQ40-15-4SQG	40	15	4	380	2850	65	71*28*34
80WQ50-12-4SQG	50	12	4	380	2850	80	71*28*34
100WQ70-9-4SQG	70	9	4	380	2850	100	71*28*34
50WQ18-35-5.5SQG	18	35	5.5	380	2050	50	79*28*34
65WQ30-25-5.5SQG	30	25	5.5	380	2850	65	79*28*34
80WQ50-16-5.5SQG	50	16	5.5	380	2850	80	79*28*34
100WQ70-12-5.5SQG	70	12	5.5	380	2850	100	79*28*34
50WQ20-40-7.5SQG	20	40	7.5	380	2850	50	79*28*34
65WQ30-32-7.5SQG	30	32	7.5	380	2050	65	79*28*34
80WQ45-22-7.5SQG	45	22	7.5	380	2850	80	79*28*34
100WQ70-17-7.5SQG	70	17	7.5	380	2850	100	79*28*34
150WQ140-10-7.5SQG	140	10	7.5	380	2850	150	79*28*34

Pump Curve

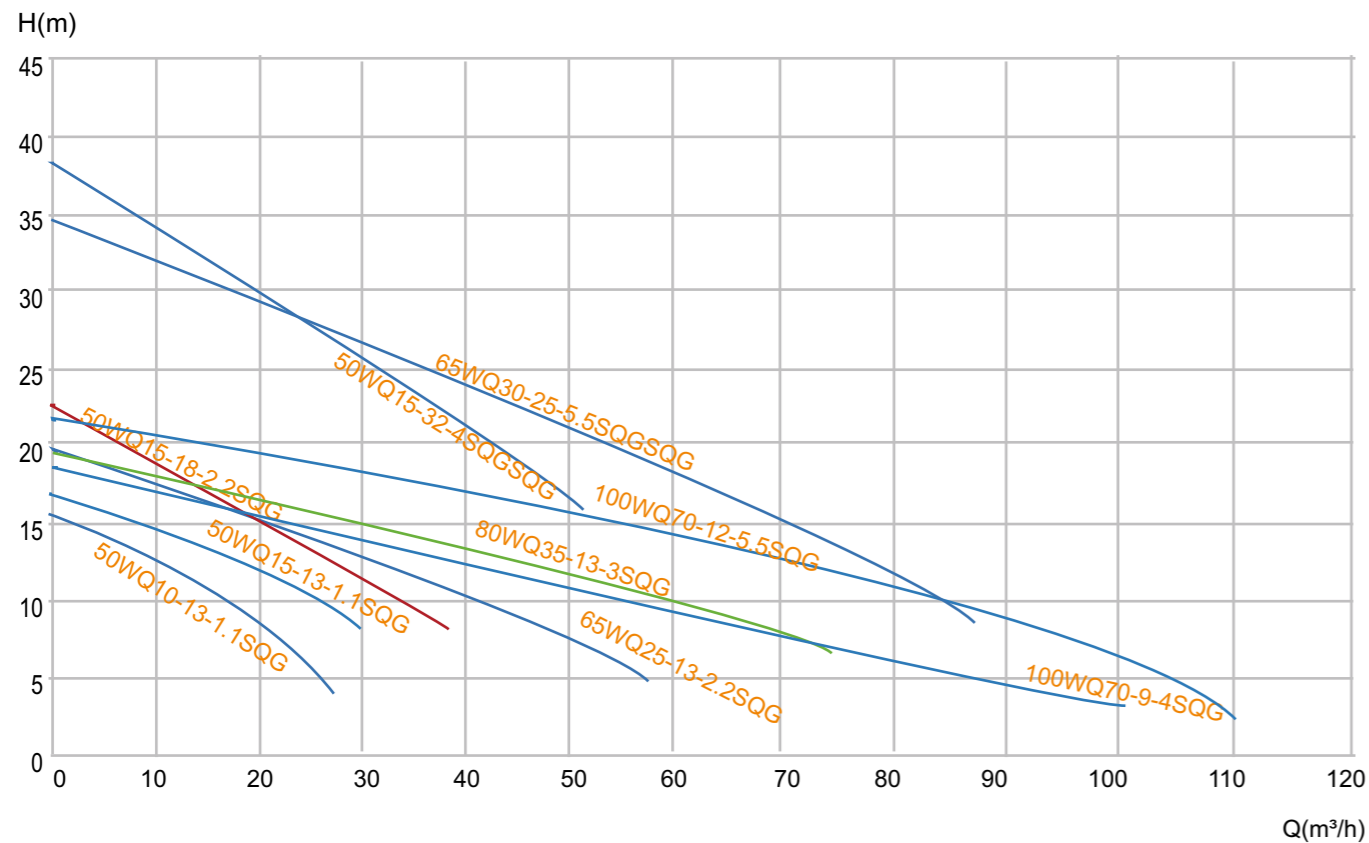

DN

STAINLESS STEEL COUPLING



Coupling installation Size

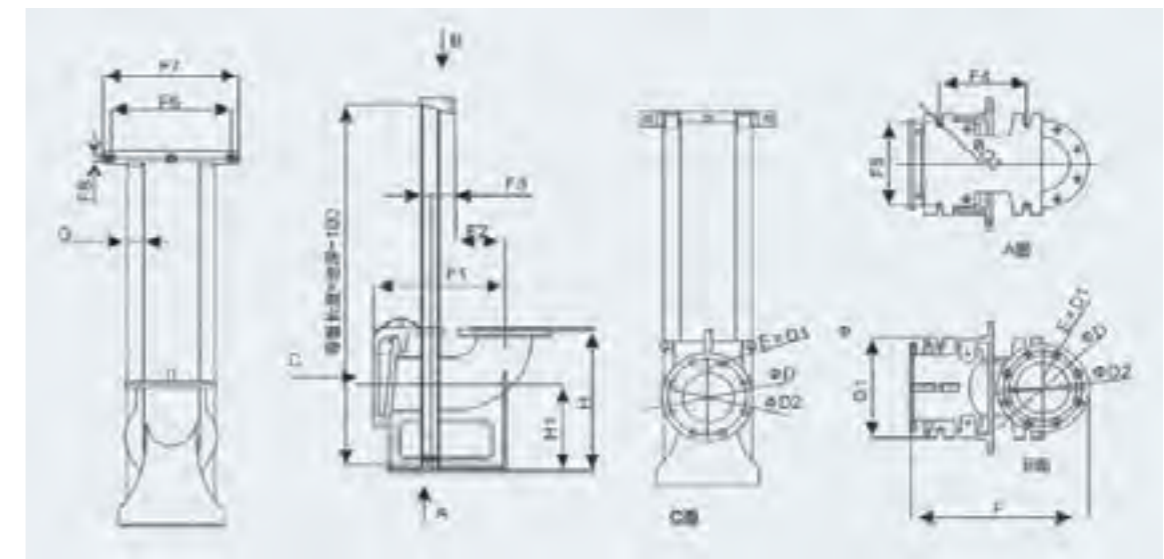

Coupling Model

Model	D	D1	D2	D3	E	F	F1	F2	FE	F4	F5	F6	F7	FB	G	G1	H	H1
DN50	110	14	50	16	4	265	195	58	62	115	113	215	255	12	1	130	215	133
DN65	130	14	65	16	4	295	215	55	65	132	135	215	255	12	1	160	246	150
DN80	150	18	80	16	4	340	245	65	75	160	160	266	315	12	1.5	185	280	170
DN100	170	18	100	20	4	370	268	80	90	192	160	305	355	14	1.5	206	330	195
DN150	225	18	150	20	8	515	3B5	147	70	252	252	350	395	14	1.5	310	425	260
DN200	280	18	200	20	8	560	400	200	a0	320	285	300	400	16	2	360	520	315